

A. J. WATSON

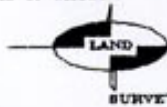

P.O. BOX 423 OR 224 DATE STREET
ST. JAMES CITY, FLORIDA 33904
PHONE (841) 283-1518
LR # 2838

CHARLOTTE HARBOR

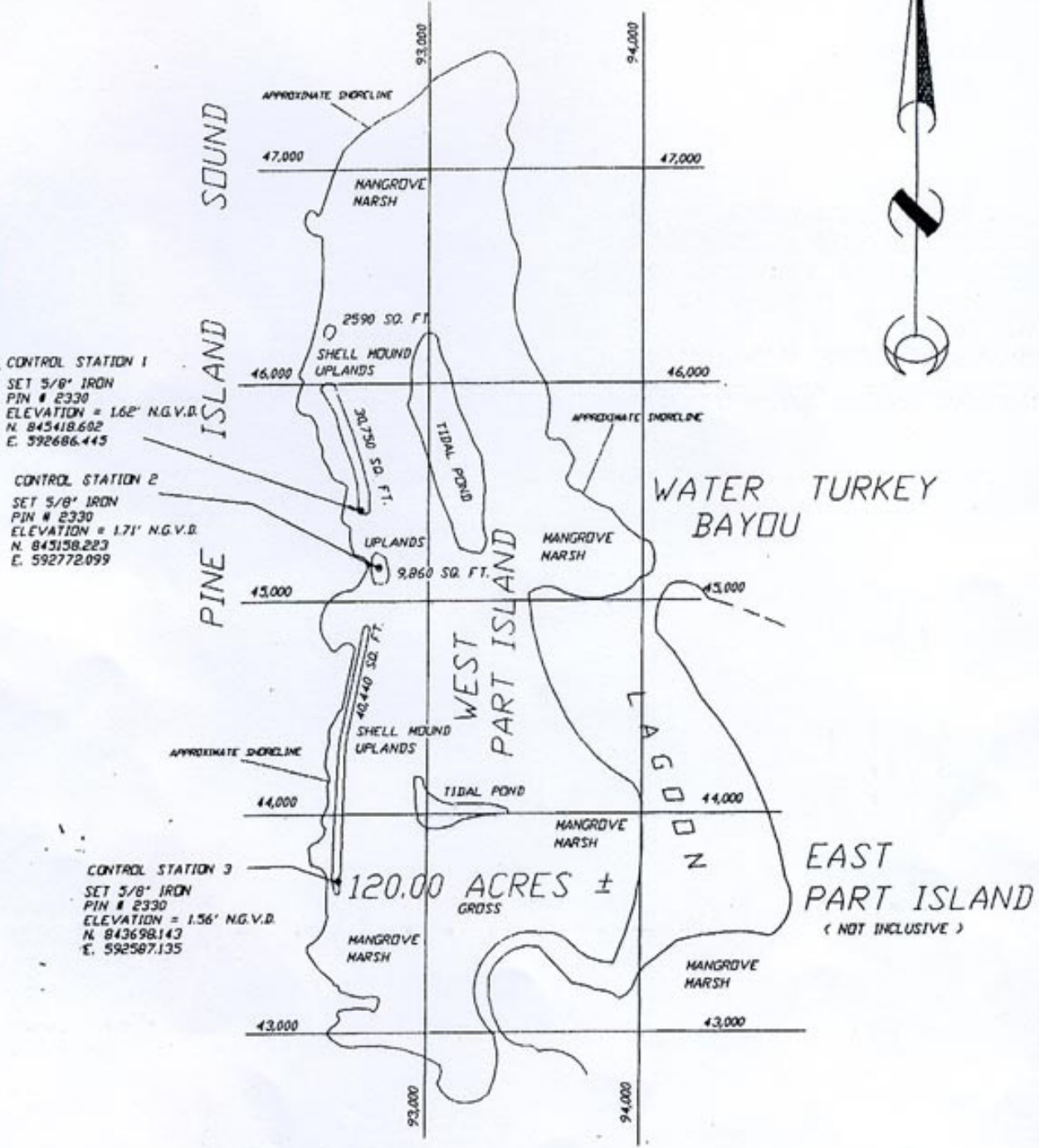

BOUNDARY & LOCATION SURVEY OF
WEST PART ISLAND LYING IN SECTIONS 3 AND 10,
TOWNSHIP 44 SOUTH, RANGE 21 EAST, LEE COUNTY, FLORIDA.

NOTE: COORDINATES SHOWN HEREON ARE BASED ON STATE PLANE COORDINATE 1985, ZONE FLORIDA WEST.
ELEVATIONS BASED ON N.G.V.D.-29, BENCH MARK H-241

This survey is in compliance with the minimum technical standards as set forth in Chapter 61C17-6, Florida Administrative Code. This Survey Map is not valid without the signature and raised seal of a Florida Licensed Surveyor and Mapper.

Alfred J. Watson
ALFRED J. WATSON
PROFESSIONAL SURVEYOR AND MAPPER
#2330 - STATE OF FLORIDA

FOR: HAGERMAN
JOB # 02-0376 F.B. L FILE
STRAP # _____

SKETCH OF SURVEY
SCALE 1" = 300'

DATE: JULY 8, 2002
DATE: _____
DATE: _____